

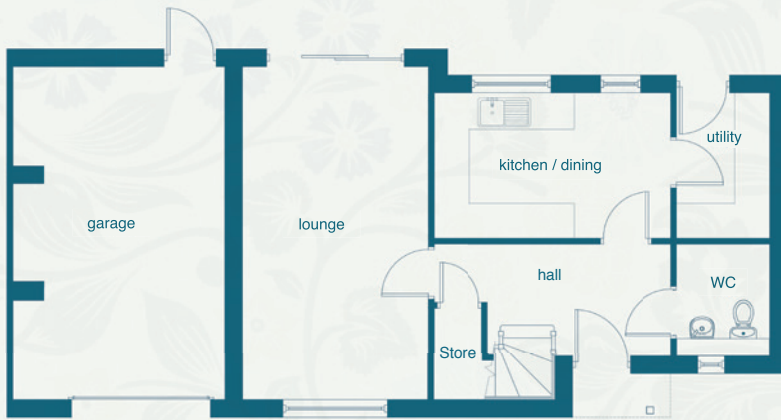

### Ground Floor



An impressive 4 bedroom semi-detached home with single integral garage and ample driveway. Downstairs has spacious living accommodation with a separate lounge, a kitchen/diner and utility room.

Upstairs is a master bedroom with en-suite shower room and 3 bedrooms plus a family bathroom.

### Ground Floor

**Hall**  
1900mm x 4050mm (max) | 3150mm (min)  
6' 3" x 13' 3" (max) | 10' 4" (min)

**Lounge/Dining**  
5750mm x 3250mm  
18' 10" x 10' 8"

**Kitchen**  
2525mm x 4100mm  
8' 3" x 13' 5"

**Utility**  
2525mm x 1625mm  
8' 3" x 5' 4"

**Cloaks**  
1900mm x 1625mm  
6' 3" x 5' 4"

### First Floor

**Master Bedroom**  
4550mm (max) | 2630mm (min) x 3500mm (max) | 1580mm (min)  
14' 11" (max) | 8' 7" (min) x 11' 5" (max) | 5' 2" (min)

**En-Suite**  
1820mm x 1820mm  
5' 11" x 5' 11"

**Bedroom 2**  
2425mm x 3250mm  
7' 11" x 10' 8"

**Bedroom 3**  
2225mm x 3250mm  
7' 3" x 10' 8"

**Bedroom 4**  
5750mm x 2670mm  
18' 10" x 8' 9"

**Bathroom**  
1975mm (max) | 1745mm (min) x 2225mm  
6' 5" (max) | 5' 8" (min) x 7' 3"

### First Floor

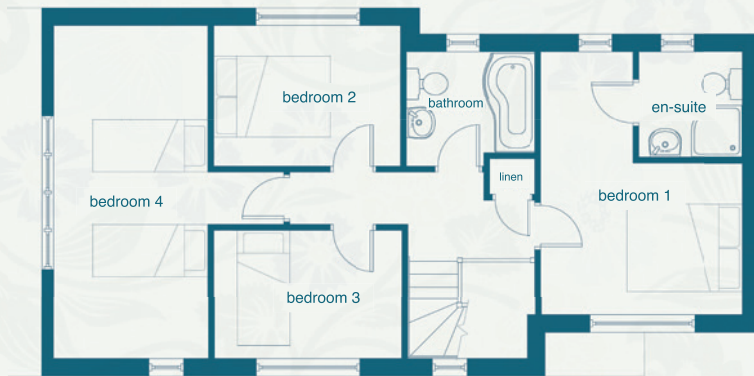

## Winding Way

### Bussey & Armstrong Homes

These particulars and dimensions are set out as a general outline only for the guidance of intending purchasers. They do not constitute, nor constitute part of, an offer or contract and are not intended to induce same. Intending purchasers must satisfy themselves as to the correctness of them. Internal layouts and window positions may vary depending on plot.



Sales: 01325 365 717 Office: 01325 462 137  
www.busseyarmstrong.co.uk