

The Carlton

A stunning 4/5 bedroom detached family home.

Spacious and bright open plan living.

A wonderful family home.

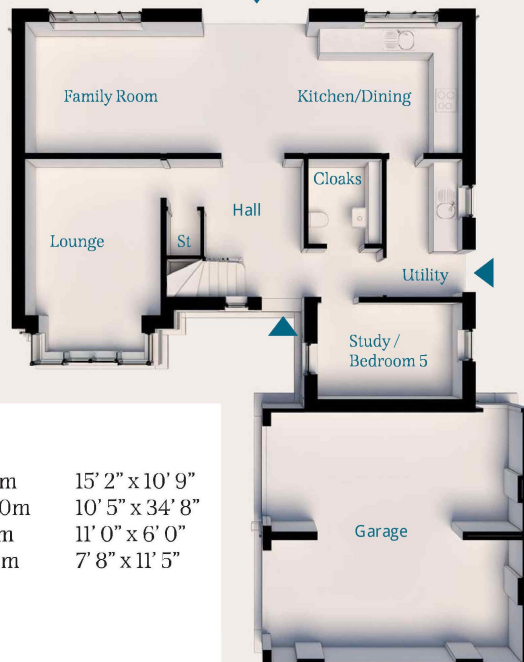

Ground Floor

Lounge	4.63m x 3.32m	15' 2" x 10' 9"
Kitchen/Family	3.20m x 10.60m	10' 5" x 34' 8"
Utility	3.36m x 1.82m	11' 0" x 6' 0"
Study/Bedroom 5	2.38m x 3.50m	7' 8" x 11' 5"

First Floor

Master Bedroom	7.11m x 3.54m	23' 3" x 11' 6"
En-suite	3.30m x 2.10m	10' 8" x 6' 9"
Bedroom 2	3.50m x 4.20m	11' 5" x 13' 8"
Bedroom 3	3.50m x 4.02m	11' 5" x 13' 2"
Bedroom 4	3.55m x 3.04m	11' 6" x 10' 0"
Bathroom	3.50m x 2.22m	11' 5" x 7' 3"

All dimensions are maximum.